



Lewin  
real estate



7A Charlton Street BENTLEIGH VIC

3 2 2

Flushed with streams of beautiful sunlight and tucked at the rear of just two in the block, this peaceful single-level townhouse delivers surprising space in a prized parkside cul-de-sac.

**Price** : \$ 1,222,000

**View** : <https://www.lewinrealestate.com.au/sale/vic/bayside/bentleigh/residential/house/8014991>

With a very liveable layout that will hold enormous appeal for young families and downsizers alike, the accommodation provides two generous living areas offering space to relax, entertain or simply dine with family. The kitchen is light and bright and features a very workable footprint plus a casual breakfast bar, while outside the north-facing patio gives a private low maintenance setting to enjoy the fresh air. Full-width rear access from the double auto garage allows part of the space to be used for trailer parking or similar if needed.



**Brian Lewin**  
0434047939



**John Hassett**  
0437452514

Inside, the three bedrooms are well proportioned, each one offering wardrobing and able to accommodate a double bed, the master boasting a walk-through robe to its fresh ensuite. A full main bathroom with separate WC is also included along with a laundry plus linen & pantry cupboards while ducted heating and a split system round off the package,

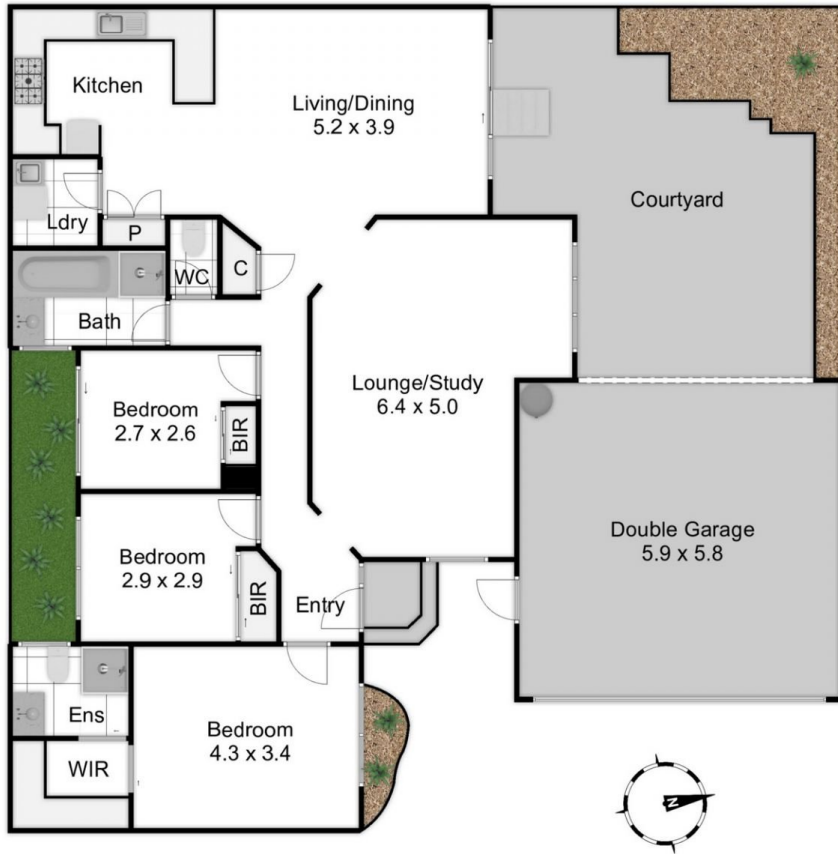

**Lewin**  
real estate

7A Charlton Street  
Bentleigh

This floorplan is a sketch. All data shown is general only.  
NB: All dimensions stated are approximate only and should not be taken as definite.