



24/128-130 Beach Road PARKDALE VIC

2 1 1

Retire and rest easy in this quiet, low maintenance 2 bedroom, 1 bathroom unit.

Comprising of a casual living and dining area, original kitchen with updated appliances, 2 good size bedrooms with built in robes and a hybrid bathroom/laundry. Nestled at the rear of the property with Bay views, the villa has been freshly painted and has new carpet throughout.

Maintain a sense of independence in the sought after 'Seacliff Village' over 55s community, with the comfort of 24 hour emergency system and support Centre management, the Village also has an on-site first-aid trained manager. While the lifestyle location speaks for itself, Opposite the new Parkdale Yacht Club and spectacular wide-open beaches, with the 903 bus stop at your door taking you between Mordialloc and Mentone Villages, walk to the peaceful charm of Parkdale Village with its lovely cafes and restaurants, or catch the train to Southland and beyond into the city.

Type : Unit
Price : PRICE REDUCTION Make an Offer \$340,000 to \$350,000
View : <https://www.lewinrealestate.com.au/sale/vic/bayside/parkdale/residential/unit/8039269>



Brian Lewin
0434047939



Sharon Begg
0433281195

[For full version visit the website](https://www.lewinrealestate.com.au)

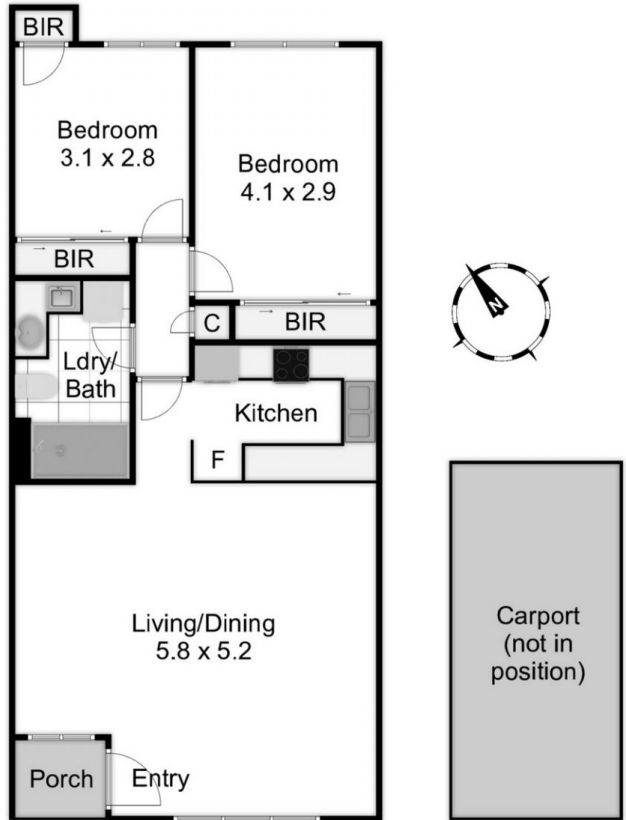

Lewin
 real estate

24/128-130 Beach Road
 Parkdale

This floorplan is a sketch. All data shown is general only.
 NB: All dimensions stated are approximate only and should not be taken as definite.