



**4 Goulburn Street CHELTENHAM VIC**

3 1 2

Instantly captivating thanks to its picture-perfect façade, this beautifully reimagined Californian bungalow is a first-class offering in a location to match. Stylishly finished, its accommodation is move-in-ready - but also comes with the bonus of approved plans & permits for a state-of-the-art extension for those seeking more space down the track.

Set within meticulously manicured gardens complete with a traditional white picket fence, the home's timeless exterior opens to interiors that are crowned by soaring decorative ceilings and highlighted by lime-washed Baltic Pine floors and intricate fretwork. Warm and inviting, the home includes a welcoming lounge with gas fireplace along with a designer kitchen with freestanding Smeg oven, marble-topped island, timber benchtops and a walk-in pantry. An updated magazine-worthy bathroom with wet area and brushed nickel tapware is a highlight of the accommodation - there is a second WC in the smartly-appointed laundry.

Bedrooms are of generous proportions and benefit from fitted storage while a rear sunroom/study is an invaluable inclusion - perfect for those working from home. Wrapping

**Price** : \$ 1,251,000  
**View** : <https://www.lewinrealestate.com.au/sale/vic/bayside/cheltenham/residential/house/8046736>



**John Hassett**  
**0437452514**



**Brian Lewin**  
**0434047939**

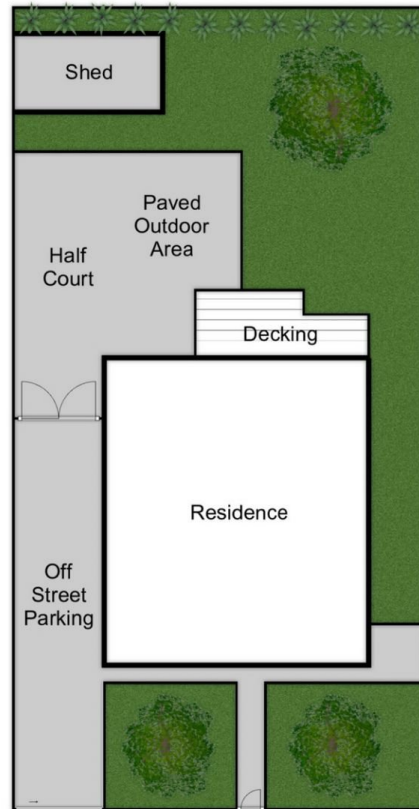

Site Plan

**Lewin**  
real estate

## 4 Goulburn Street Cheltenham

This floorplan is a sketch. All data shown is general only. NB: All dimensions stated are approximate only and should not be taken as definite.