



**G05/241 Balaclava Road CAULFIELD NORTH VIC**

2 1 1

This stylish ground-floor apartment in the "Luxor" complex, directly opposite Caulfield Park and close to Hawthorn Road's shops and cafes, is sure to impress. This park-side home features a large enclosed front courtyard with private street entry, offering a great lifestyle opportunity.

Inside, timber floors lead from the entrance hallway to an open-plan living and dining area filled with natural light. Sliding doors open to a large north-facing front courtyard, perfect for relaxing and entertaining. The modern stone kitchen includes stainless steel Miele and Fisher & Paykel appliances, including an integrated dishwasher, and plenty of storage.

Two good-sized carpeted bedrooms with mirrored built-in robes, a sparkling central bathroom, and a separate powder room complete the accommodation. Additional features include secure basement parking for one car with a storage cage and lift access, video intercom entry, split system heating/cooling, hallway storage, and a Euro laundry.

Conveniently located near public transport, parklands, Glenferrie and Hawthorn Road shopping strips, and

**Type** : Apartment

**View** : <https://www.lewinrealestate.com.au/lease/vic/east/caulfield-north/residential/apartment/8052448>

[For full version visit the website](#)

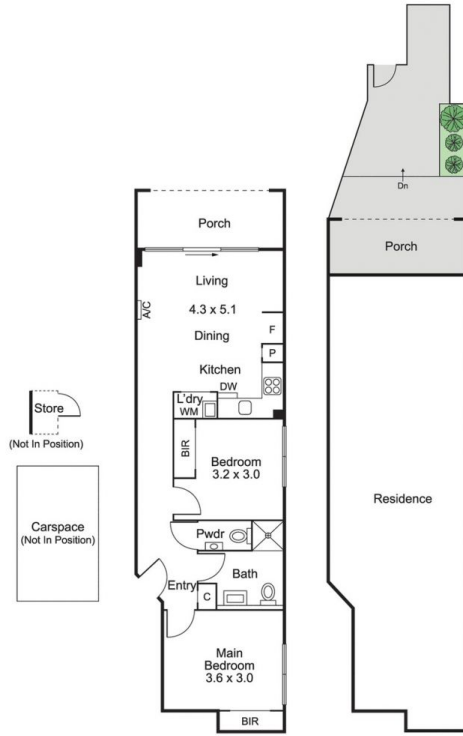

Disclaimer: The measurements and/or dimensions of both the land and property as well as any internal measurements and/or dimensions of any rooms are approximate and may not be accurate. Prospective purchasers should carry out their own measurements and enquiries and engage the services of a licensed surveyor. To the maximum extent permitted by law, Gary Peir & Associates Pty Ltd gives no guarantee or warranty whatsoever as to the accuracy or otherwise of the measurements and dimensions set out (including but not limited to errors or omissions) and expressly disclaims all liability for any loss or damage, whatever the cause, which may arise from any person acting and/or relying on such measurements and dimensions.